

Coplax AG
Sihlbruggstrasse 107, 6340 Baar - Switzerland
Phone no: +41 41 766 8330

www.stylies.ch

stylies®

AQUARIUS - AIR WASHER



Gebrauchsanweisung Deutsch	2
Instruction Manual English	8
Mode d'emploi Français	14
Istruzioni d'uso Italiano	20
Instrukcja obsługi Polski	26
Gebruiksaanwijzing Dutch	32
Användarhandbok Svenska	38
Instrucciones de uso Español	43
Návod k použití Čeština	49
Návod na použitie Slovenský	54

stylies®

AQUARIUS

LUFTWÄSCHER - AIR WASHER

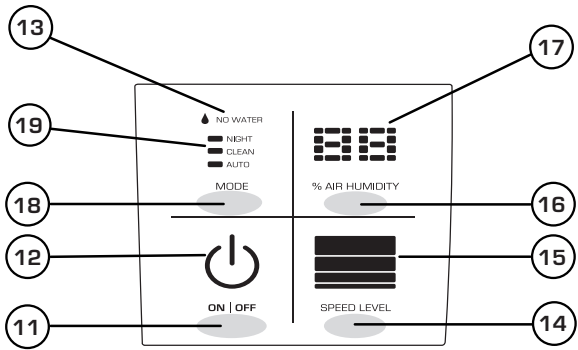
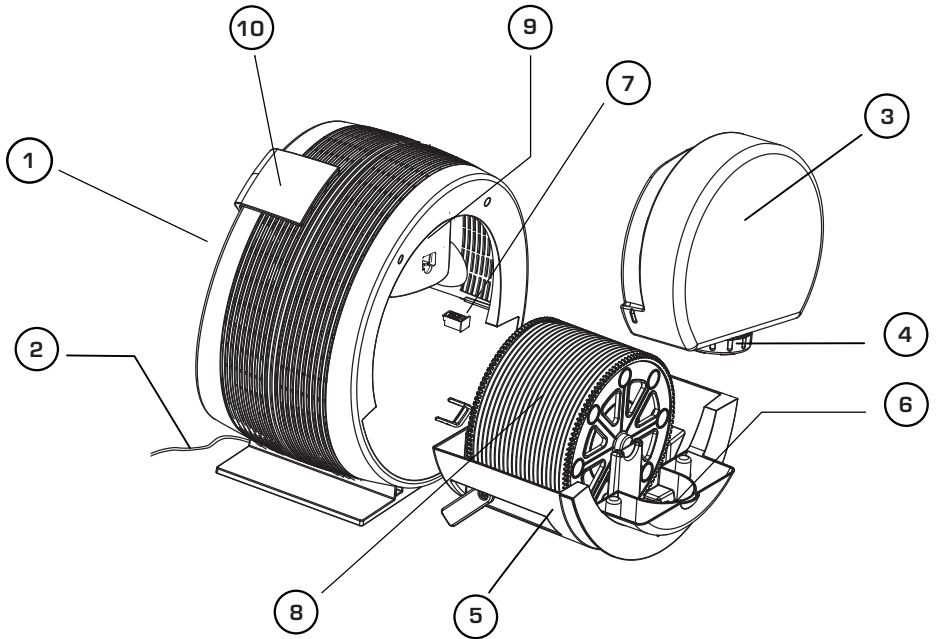

Congratulations! You have just acquired the outstanding 'Stylios Aquarius' air washer. It will give you great pleasure and will significantly improve the quality of your indoor air.

As for all domestic electrical appliances, this device requires also particular attention and care in order to avoid injury, fire or damages to the appliance. Please read these operating instructions carefully before using the appliance for the first time and follow the safety advices mentioned on the units.

DESCRIPTION OF THE DEVICE:

This device consists of the following main components:

1. Air washer
2. Power cable
3. Water tank
4. Water tank cover
5. Water tray
6. Clean Cube
7. Aroma box
8. Disc assembly
9. Fan
10. Control panel / Display
11. On/Off control
12. On/Off indicator
13. 'No water' indicator
14. Fan speed control
15. Speed indicator
16. Humidity control
17. Humidity indicator
18. Mode control
19. Mode indicator

IMPORTANT SAFETY GUIDELINES

- Please read through the operating instructions carefully before you use the appliance for the first time and keep them safely for later reference; if necessary pass them on to the next owner.
- Coplax AG refuses all liability for loss or damage which arises as a result of failure to follow these operating instructions.
- The appliance is only to be used in the home for the purposes described in these instructions. Unauthorised use and technical modifications to the appliance can lead to danger to life and health.
- This appliance can be used by children aged from 8 years and above and persons with reduced physical, sensory or mental capabilities or lack of experience and knowledge if they have been given supervision or instruction concerning use of the appliance in a safe way and understand the hazards involved. Children shall not play with the appliance. Cleaning and user maintenance shall not be made by children without supervision.
- Only connect the cable to alternating current. Observe the voltage information given on the appliance.

- The device must always be unplugged:
 - before the device is moved to another place
 - before the device is opened or when it is refilled with water
 - in the case of malfunction
 - before any cleaning
 - after each use.
- Do not use damaged extension cords.
- Never carry or pull the device by the power cable.
- Penetrating the housing is strictly prohibited.
- Do not run the power cord over sharp edges and make sure that it does not get trapped.
- Do not pull the plug from the socket with wet hands or by holding on to the power cord.
- Do not use the appliance in immediate vicinity of a bath tub, a shower or a swimming pool (observe a minimum distance of 3 m). Place the appliance such that a person in the bath tub cannot touch the appliance.
- Do not place the appliance near a heat source. Do not subject the power cord to direct heat (such as a heated hotplate, open flames, hot iron sole plates or heaters for example). Protect power cords from oil.
- Do not position the device directly next to walls, curtains or furniture.
- See to it that the appliance is properly positioned to ensure a high stability during its operation and make sure that no one can trip over the power cord.
- The appliance is not splash-proof.
- For indoor use only.
- Do not store the appliance outdoors.
- Store the appliance in a dry place inaccessible to children (pack the appliance).
- Do not add anything to the water (fragrances, essential oils or water fresheners).
- If the power cord is damaged, it must be replaced by the manufacturer or a repair shop authorized by the manufacturer or by similarly qualified persons in order to avoid a hazard.
- Prior to any maintenance, cleaning and after each use, switch off the appliance and unplug the mains cable from the socket.

Do not place the device directly on the floor. Use a water-proof underlay!

FIRST USE / OPERATION

1. Place the AQUARIUS on a flat surface in your desired location. Plug the Power cable (2) into the power socket.
2. Pull the Water tray (5) out (approx. 4 cm) until you are able to lift the Water tank (3). Remove the Water tank cover (4) and fill the Water tank (3) with fresh clean water (max. 4.5 litres). Tight the Water tank cover (4) back onto the Water tank, and place the Tank onto the device.
3. Please note: Do not move the Aquarius whilst it is filled with water as the water might come out from the Tray.
4. The Aquarius is controlled via its Control panel (10). Start the air washer by pressing the On/Off control (11). Please note that a gentle touch is sufficient (touch screen). Subsequently the On/Off indicator (12) should be lighted and the device starts. If the red 'no water' indicator (13) is illuminated, Aquarius can not start working due to the lack of water in the Water tank (3).
5. The humidity output of the device depends on the running speed of the Fan (9). In the "manual" Mode, you can select from 4 different speed settings by pressing the Fan speed

- control [14] on the Control panel [10] , and set it at your desired output level (low, medium, high, or turbo).
6. In "manual" Mode, the desired humidity level can be set (40-75% and continuous operation 'Co') manually by pressing the Humidity control [16] repeatedly (the Humidity indicator [17] blinks with the desired humidity level selected). A few seconds after this input has been taken, the indicator [17] stops blinking and switches to show the current room humidity level again.
 7. Information: Once the desired humidity is reached, the device stops and the Humidity indicator [17] blinks. The device measures the humidity level every 30 minutes (when the device is measuring the humidity the Fan [9] will be still running for 1-2 minutes). If the measured humidity level falls below the set value, the device starts the humidification process again, and the Humidity indicator [17] stops blinking.
 8. Mode 'M' – the device has 3 different pre-programmed modes: Clean, Auto, and Night. You can select and change among these modes by pressing the 'Mode' control [18] on the Control panel [10].
 9. Clean mode: This mode is ideal for cleaning and descaling the device. Under this mode, the Disc assembly [8] is powered but the Fan [9] is not running, therefore, no air is blown into the room.
 10. Auto mode: Under this mode, Aquarius is set automatically to keep the humidity level at 45%. The lower the current room humidity level is, the higher the speed of the Fan and therefore the higher the humidity output is selected by the program.
 11. Sleep mode: this mode is ideal when you want the device run quietly during the night. The illumination is dimmed and the device is set to a humidity level of 45%. The humidification output (Fan speed) is set at its lowest level.
 12. You can also use Aquarius to disperse fragrances in the room air. To add fragrance, you can draw out the Aroma box [7] from its tray and pour less than 2 drops in the box, and then put it back into the tray. We ask your kind attention to use as less as possible the fragrance in the Aroma box, an excessive dosage may result in malfunctions and even damages to the device.
 13. Tip: If you wish to change the fragrance to a different one, draw out the Aroma box [7] from its tray, clean the plastic cage with soap and replace the cotton inside the box with a new one. Now Aquarius is ready again to take a new fragrance and to disperse in your room air.
 14. As soon as the 'no water' LED indicator [13] is illuminated in red, the Water tank [3] must be refilled. Pull out the Water tank and the Water tray [5] until you are able to lift the tank [3] (approx. 4 cm), take off the Water tank cover [4] from the Water tank and fill the Tank with clean fresh water (approx. 4.5 liters). Put the Tank cover [4] back onto the Tank tightly and put the tank into the Tray [5], push the tray gently back to its original position. After the tank has been placed into the device, the Aquarius will restart automatically in a few seconds.

CLEANING

After each use and before the maintenance, the device must be switched off and the power cable must be disconnected from the power socket. Therefore, before the cleaning of Aquarius, you must disconnect the power cable [2] first.

Please note: Never immerse the device in water (risk of short circuit).

- To clean the surface of the device, wipe off the dusts with a damp cloth and then dry thoroughly.
- To clean the inside parts of the device, you should pull out the Water tray [5] containing the Disc assembly [8]. This Disc assembly [8] and the Water tank [3] need to be cleaned every 2 weeks. Thoroughly clean the container using a brush. If there are lime scales, please soak the container in a descale-agent and then rinse with clean water thoroughly. In order to clean the

Water tank (3), just rinse the tank with warm water thoroughly. If there are lime scales in the tank, you can also use descale-agents for cleaning the inside of the Water tank. Subsequently, rinse the water tank with clean water after descaling and then dry it.

- The Disc assembly (8) should be cleaned approx. every 4 weeks: First pour out the remaining water in the Tray (5). Second, fill the Tray (5) with descaling agent (better mixed with clean water) up to the level of the upper edge of the float. Push the Tray back into the chamber again (without the Water tank), plug in the Power cable and run the device under its 'Clean' mode (see also section 6 under Start-up/Operation). Let the device run under this Clean mode till all the lime scales are dissolved in the descaling agent.

Information: Under the 'Clean' mode, the Fan (9) is not running. Only the Disc assembly (8) turns around within the descaling agent, therefore, there will be no airflow coming through the unit.

CLEAN CUBE

The Clean Cube TM (6) is made with a special patented material. It prevents the growth of germs and bacteria in the water by constantly releasing silver ions. This stick creates hygienic for your room climate. Its effectiveness can last for one year. Therefore, we recommend you to change this accessory for each new humidification season.

This Clean Cube TM becomes effective as soon as and as long as it contacts with water, so, even when the device is switched off, its preventing effectiveness works.

USEFUL INFORMATION

Information on how an air washer works:

The air washer 'washes' the air by pulling it through the wet discs. Particles contained in the airflow will be trapped and stick onto the wet discs, and then washed off in the water basin and remain at the bottom of the water tray. This device is an ideal combination of air humidifier and air purifier, particularly suitable for cleaning pollen, dust and other particles contained in the air and for keeping the humidity in the room at an optimum level – without the need to change the filters. The ideal humidity level for our health and well beings, as recommended by doctors, is between 40% and 60%.

Tips for water:

Clean water must always be used to ensure that the air remains hygienic to breathe. The device, and the water tank in particular, must always be hygienically clean. Recommendation: always use the Clean Cube, as this reduces the formation of germs in the water.

Hygrostat:

The standard-tolerance of an integrated hygrostat is +/- 10%. That means the effective relative humidity level can deviate accordingly.

TROUBLE-SHOOTING

Display cannot be switched on:

Water basin not inserted properly. Remove and reinsert.

REPAIRS / DISPOSAL

- Repairs to all electric devices (including replacement of the power cable) may only be performed by instructed experts. Carrying out inappropriate repairs voids the warranty and no liability shall be accepted.
- If the power cable has become damaged, it must be replaced by the manufacturer, his official service partner or a qualified person, in order for further damage to be avoided.
- Never operate the device if the cable or the plug is damaged, after the device has malfunctioned, if it has been dropped or if it has been damaged in any other way (i.e. with cracks or breakages to the housing).
- Do not use any sharp, abrasive objects or corrosive chemicals.
- Disable devices that are to be discarded immediately (by cutting off the power cable) and dis-

- pose of them at an appropriate waste collection centre.
- Do not dispose of electrical devices in the household refuse. Use the official recycling collection centres, where available.
- If electrical devices are disposed off in an unregulated way, the effects of weathering can cause hazardous substances to contaminate the groundwater and the food-chain or this can result in a burden on flora and fauna for years to come.



This device must not be disposed of with household refuse. Please dispose of this device at the appropriate waste collection centre. Collecting and recycling electrical and electronic waste saves valuable resources.

The packaging material is recyclable. Dispose of the packaging in an environmentally friendly way and ensure that it reaches the recyclable material collection centre.

TECHNICAL DATA

Humidifying capacity:	300g/h
Power consumption:	max. 15 watt
Dimensions:	392 mm x 295 mm x 401 mm (length x width x height)
Net weight:	5.6 kg
Water tank capacity:	4.2 litres
Noise level:	ca. 31 dB(A)
Fulfils EU regulations	CE/WEEE/RoHS

Subject to technical changes without notice.

TWO-YEAR WARRANTY

For the warranty period of 2 years after the purchase of the appliance, we will repair or replace with a refurbished product (at our option), without any cost to you for either the parts or labor, any machine or part that proves to be defective in materials or workmanship.

EXCEPT FOR THE WARRANTY PROVIDED ABOVE, Coplax DISCLAIMS ANY AND ALL OTHER IMPLIED WARRANTIES AND ANY WARRANTY OF MERCHANTABILITY OR FITNESS FOR A PARTICULAR PURPOSE WITH RESPECT TO THE PRODUCT FOR ANY PERIOD AFTER THE EXPIRATION.

Coplax will, at its sole discretion, repair or exchange a product under warranty. NO credit will be issued. The remedies described above are your sole remedies in the event of any breach of the warranty provided above

WHO IS COVERED:

The original owner of a privately-owned Coplax appliance who can provide a dated proof of purchase in the form of an invoice or receipt is covered. The warranty is not transferable. The original dated proof of purchase [a copy needs to be faxed, e-mailed, mailed] prior to returning the unit. Provide the model number of your appliance and a detailed description (preferably typed) of the problem with the item. Enclose your description in an envelope and tape it directly to the appliance before the box is sealed. Do not write anything on or alter in any way the original box.

WHAT THIS WARRANTY DOES NOT COVER:

- Parts that normally require replacement, such as demineralization cartridges, Clean Cube, active carbon filters, water wick filters and any other consumable item that needs regular replacement except for material or workmanship defects.
- Damage, failure, loss or deterioration due to ordinary wear and tear from abuse, misuse, negligence, accident, faulty installation, placement and operation, improper maintenance, unauthorized repair, exposure to unreasonable temperatures or conditions. This includes damages caused by misusing essential oils or water treatment and cleaning solutions.

- Damage resulting from inadequate packaging or carrier mishandling of returned products.
- Misplacement or loss of accessories such as nozzle, fragrance capsule, water tank cap etc.
- Shipping and transportation costs to and from any place of repair.
- Direct, indirect special or consequential damages of any type, including loss of profits or other economic loss.
- Transportation damage of a unit shipped from one of our retailers. Please contact them directly.

This Warranty does not cover damages or defects caused by or resulting from failure to conform strictly to Coplax's specifications in connection with the installation, operation, use, maintenance, or repair of the Coplax appliance.